

**Characteristics**

Model No.	Input	Relay
SNC05-E-A	12~24V	12~24VDC
SNC05-E-B	48~60V	48~60VDC
SNC05-E-C	110V	60VDC
SNC05-E-D	230V	60VDC

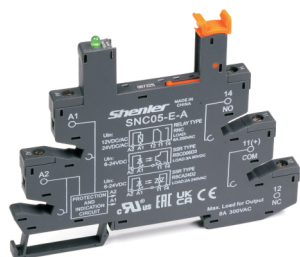

**SNC05-E**

Characteristics			
Nominal load	Current	A	8
	Voltage	V	300
Dielectric strength	Between coil and contact	V/min	4000
	Between contacts	V/min	2500
Max. tightening torque		Nm	0.5
Wire size		AWG/mm <sup>2</sup>	20-16/0.5-1.5
Ambient temperature		°C	-40~+85
Unit weight		g	24

Accessories		
Bus jumper	Legend	Partition plate
		
SN20B	SN64P	SN20S

**Dimensions (mm)**

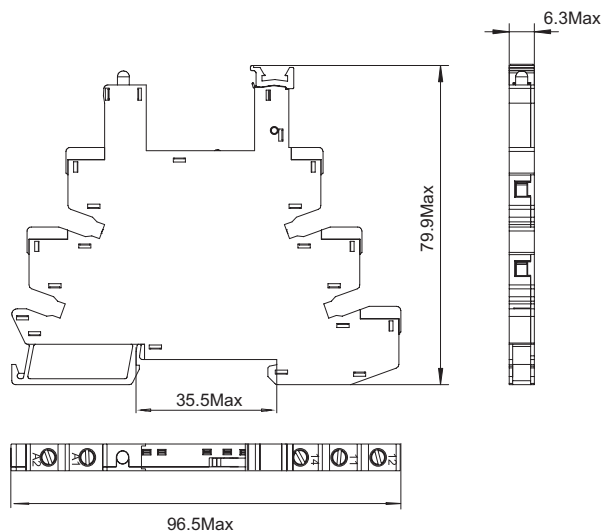

**Connection Diagrams**

